

Bolt Holes as Per  
ASME B16.5 150#  
Dimensions

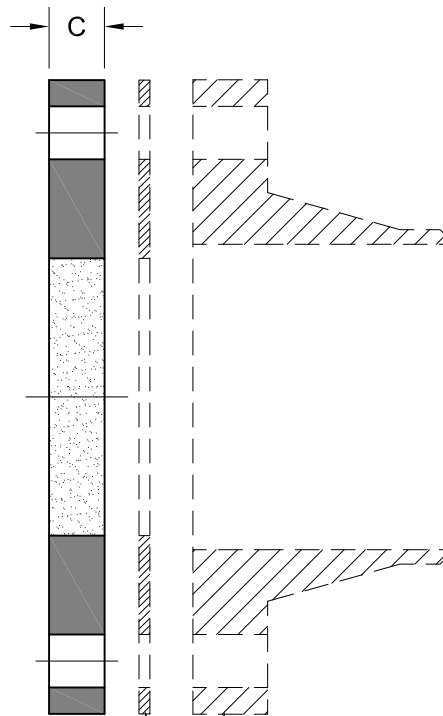

Gasket, Mating Flange, &  
Hardware Not Included

**WETTED MATERIALS**

**Ring:**

Carbon Steel (14°F to 572°F)  
Duplex 2205 Stainless Steel (-22°F to 536°F)

**Glass:**

Fused Borosilicate

**RATINGS:**

150 PSIG / 10.34 Bar

**PRODUCT SPECIFICATIONS**

Flange Size	A		B		C		Weight		# of Holes
	In.	mm.	In.	mm.	In.	mm.	lbs.	kg.	
1-1/2	5.0	127.0	1.57	40	0.63	16	0.6	1.4	4
2	6.0	152.4	1.97	50	0.79	20	1.1	2.5	4
2-1/2	7.0	177.8	2.36	60	0.79	20	1.5	3.4	4
3	7.5	190.5	2.95	75	0.79	20	1.7	3.8	4
4	9.0	228.6	3.94	100	0.79	20	2.4	5.4	8
6	11.0	279.4	5.51	140	0.98	25	4.4	9.8	8
8	13.5	342.9	6.30	160	0.98	25	7.3	16.0	8

**W14 Series Configuration Choices:**

Reference the Series W14 Model Number Matrix on our Website or Inquire with our Sales Team

**Notes:**

1. Hardware and Gasket Not Included
2. Must Bolt ONLY to Flat Faced Flanges with Full Faced Gaskets

**REVISIONS**

Rev.	Modification	Date	Done By

This Drawing and the Subject Matter Disclosed Therein is the Property of John C Ernst LLC. It is Not to be Copied, Used, Appropriated or Disclosed to Others Without the Expressed Permission of John C Ernst LLC.



www.johnernst.com • 21 Gail Ct Sparta NJ USA

Series W14 Style BT - Fused Sight Glass Window - 150 PSIG

Sheet: 1 of 1	Drawn By: NPH	Tolerances, unless otherwise noted Dec.: ±   Frac.: ±1/16   Ang.: ±	Size: A
Scale: NTS	Approved By: JCW		Rev.: --
Dim.: Var.	Date: 01-NOV-17	Dwg. No.: SC2.00W14.02.0.0	